

NFS International Metal Products Co., Ltd. was founded in 2013, based in Suzhou city, Jiangsu Province, 150 kilometers from Shanghai Pudong Airport to our office.

Our main product for export business is stove and fireplace chimney pipe, which the diameter range from 80mm to 300mm, product include the single and double wall stainless steel pipe for wood burning, gas, pellets and others, the material is SUS316, SUS304, and also we can make all products according to different market request, we will provide best product, best service, and best price to have a win win business with you.

We take "customer-friendly, quality-oriented, integrative, innovative" as objectives. "Truth and honesty" is our management ideal. The customer satisfaction is our primary target. We uphold a consistent level of professionalism, quality, credibility and service, therefore we are always ready for cooperation and gladly welcome new clients and business partners.

Twist Locking System

EN 1856-1: T600-N1-D-Vm-L50050-G70(050)
T600-N1-D-V2-L50050-G70(050)

Diameter: ID125-300mm

Material: SUS316L & SUS304,
or according to customer's request

Thickness: 0.5mm/0.6mm

Insulation: Ceramic, 13/25mm thickness

Connection: Twist lock (there are some teeth on the male and female ends, just twist and teeth on the lock place, then add locking band to keep enough strong)

Straight Pipe

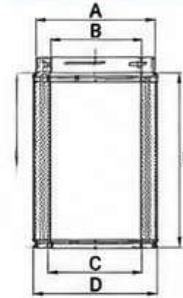

∅ (mm)	A	B	C	D	E
125	127	175	125	167	174
150	152	200	150	191	198
175	177	225	175	217	224
200	202	250	200	242	249
250	252	300	250	292	299
300	302	350	300	342	349
C	119.6	139.6	179.5	200	120

90 Degree Tee

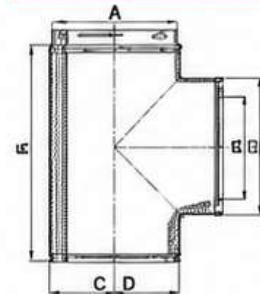

∅ (mm)	A	F	E
125	125	175	305
150	150	150	330
175	175	250	355
200	200	250	380
250	250	300	430
300	300	350	480

135 Degree Tee

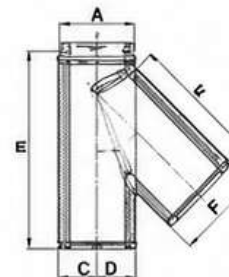

∅ (mm)	A	B	C	D	F
125	125	175	300	500	300
150	150	175	300	500	350
175	175	225	350	550	400
200	200	250	350	550	450
250	250	300	400	600	600
300	300	350	450	650	650

ABOUT US
NFS INTERNATIONAL

90 Degree Elbow

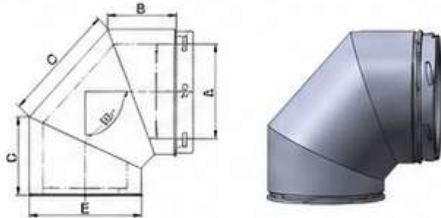

Ø (mm)	A	B	C	D	E
125	125	100	156	118	175
150	150	116	186	123	200
175	175	132	198	138	225
200	200	160	218	146	250
250	250	197	246	166	300
300	300	170	280	196	350

30 Degree Elbow



Ø (mm)	A	B	C	D	F	G	H
125	125	170	97	112	152	167	171
150	150	200	109	126	172	191	196
175	175	225	120	139	191	211	216
200	200	250	110	135	202	243	247
250	250	300	121	149	252	292	296
300	300	350	137	162	302	342	346

Wall Base Support

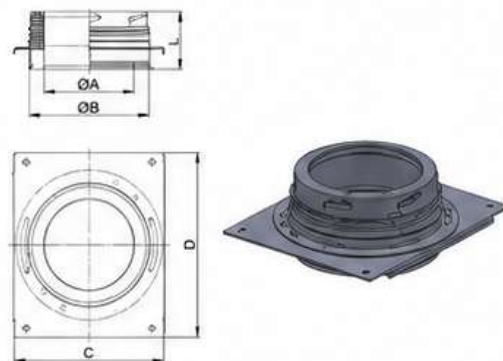

Ø (mm)	A	B	C	D	L
125	125	175	252	300	100
150	150	200	250	305	100
175	175	225	275	330	100
200	200	250	300	355	100
250	250	300	350	405	100
300	300	350	400	455	100

EN 1856-1: T600-N1-D-Vm-L50050-G7/O050
 T600-N1-D-V2-L50050-G7/O050
 Diameter: ID125-300mm
 Material: SUS316L & SUS304,
 or according to customer's request

Thickness: 0.5mm/0.6mm
 Insulation: Ceramic, 13/25/50mm thickness
 Connection: Spigot Lock with locking band to keep enough strong

Straight Pipe

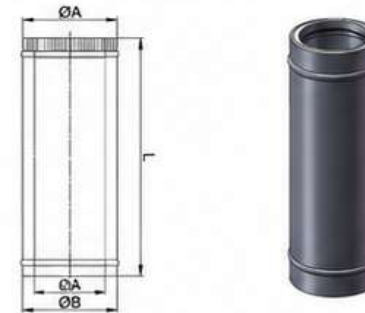

Ø (mm)	A	B	L
125	125	125	-
150	150	150	-
175	175	175	-
200	200	200	-
250	250	250	-
300	300	300	-
C	160	460	960

90 Degree Tee

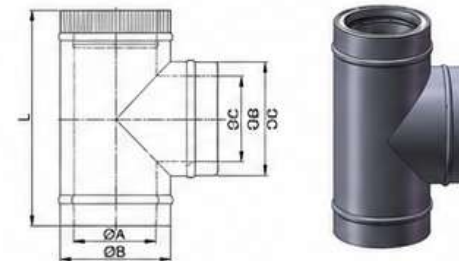

Ø (mm)	A	B	L
125	125	175	350
150	150	200	380
175	175	225	400
200	200	250	420
250	250	300	460
300	300	350	520

135 Degree Tee

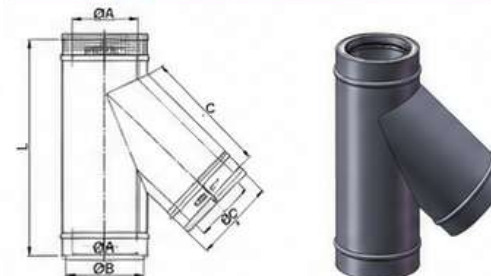

Ø (mm)	A	B	C	L
125	125	175	275	460
150	150	200	300	500
175	175	225	325	530
200	200	250	350	560
250	250	300	400	620
300	300	350	450	700

90 Degree Elbow

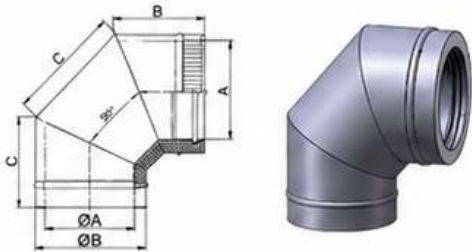

Ø (mm)	A	B	C	D	E
125	125	150	156	198	165
150	150	202	160	210	180
175	175	225	175	235	195
200	200	250	190	250	210
250	250	300	210	268	225
300	300	350	240	308	240

45 Degree Elbow

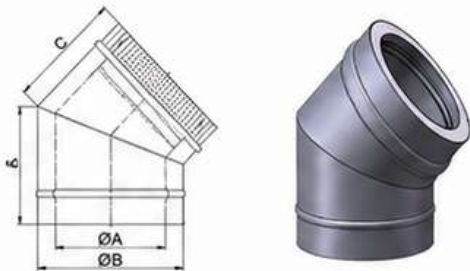

Ø (mm)	A	B	C	D
125	125	175	150	150
150	150	202	160	160
175	175	225	171	171
200	200	250	181	181
250	250	300	202	202
300	300	350	223	223

Wall Base Support

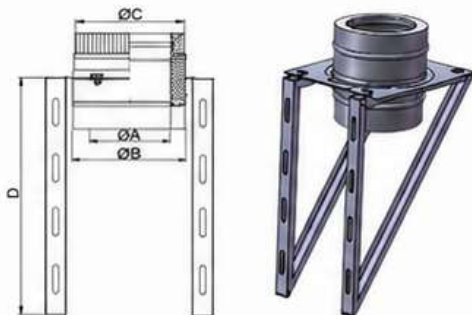

Ø (mm)	A	B	C	D	L
125	125	175	173	455	455
150	150	200	203	455	455
175	175	225	228	455	455
200	200	250	248	455	455
250	250	300	298	555	555
300	300	350	348	555	555

(According to customer's request to design how to pack the products)

Straight Pipe (Decoration)

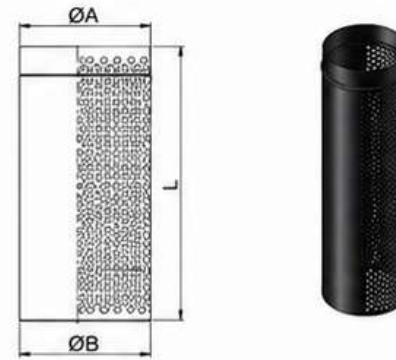

Ø (mm)	A	B	L
150	191	193	1000

45 Degree Elbow

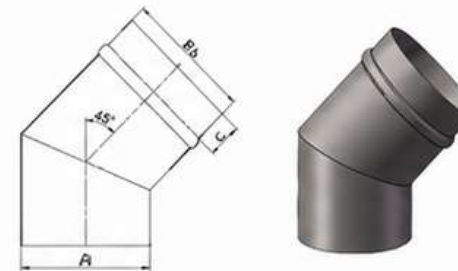

Ø (mm)	A	B
150	150	152
200	201	203
250	250	252

Rain Cap

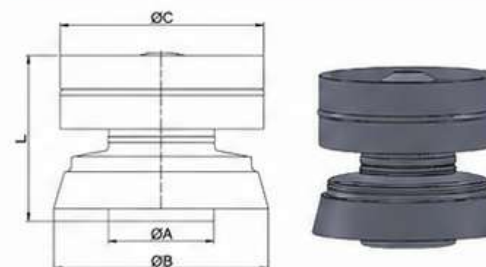

Ø (mm)	A	B	C	L
150	149	305	285	225

Wind Cowl

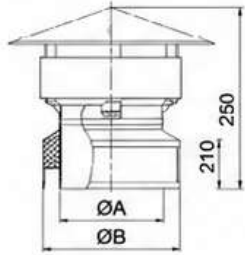

Ø (mm)	A	B
125	125	175
150	150	200
175	175	225
200	200	250
250	250	300
300	300	350

H Cowl

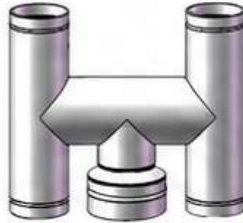
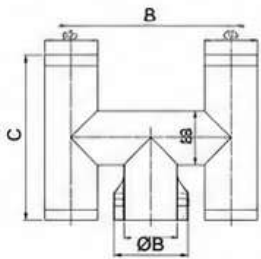

Ø (mm)	A	B	C
125	125	175	450
150	150	202	450
175	175	225	500
200	200	250	550
250	250	300	550
300	300	350	600

Terminal

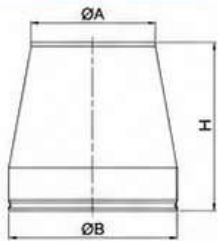

Ø (mm)	A	B	H
125	125	175	250
150	150	200	250
175	175	225	250
200	200	250	250
250	250	300	250
300	300	350	250

5-30 Degree Roof Flashing

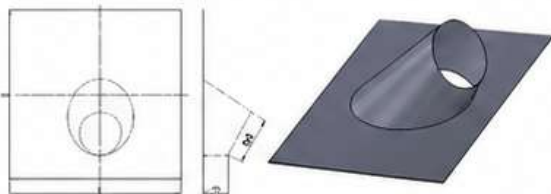

Ø (mm)	A	B	L1
125	600	700	185
150	600	700	210
175	600	800	235
200	600	800	260
250	600	900	310
300	600	900	360

Storm Collar

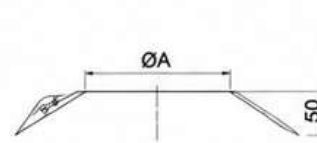

Ø (mm)	A
125	177
150	202
175	227
200	252
250	302
300	352

Trim Plate

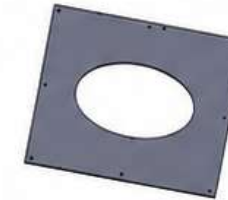
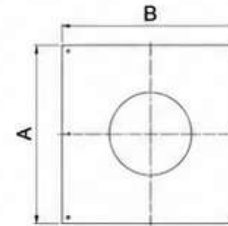

Ø (mm)	A	B
150	0°	480
150	30°	526
150	45°	560
200	0°	530
250	30°	576
200	45°	620

Twist Adaptor

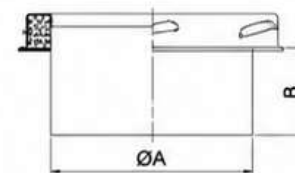

Ø (mm)	A	B
125	123	100
150	148	100
175	173	100
200	198	100
250	248	100
300	298	100

Normal Adaptor

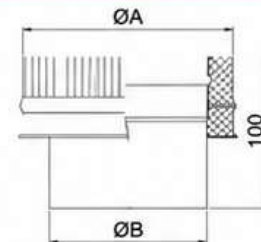

Ø (mm)	A	B
125	123	123
150	148	148
175	173	173
200	198	198
250	248	248
300	248	248

Special Adaptor

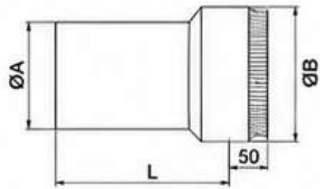

Ø (mm)	A	B	C
125	122	195	37.5
125	122	195	37.5
125	122	195	50
150	146	195	37.5
150	146	195	50

Roof Support

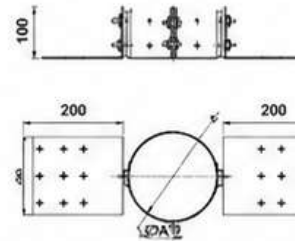

Ø (mm)	A
125	175
150	200
175	225
200	250
250	300
300	350

Roof Bracket

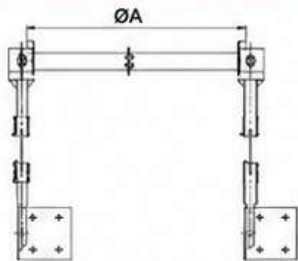

Ø (mm)	A
125	175
150	200
175	225
200	250
250	300
300	350

Ventilation Pipe

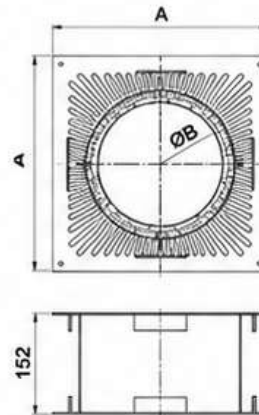

Ø (mm)	A	B
125	327	250
150	352	280
175	377	305
200	402	305
250	452	355
300	502	405

Enhanced Base Bracket

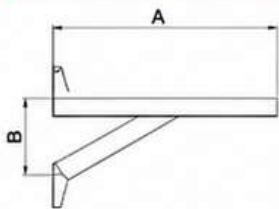

Ø (mm)	A	B
125	450	100
150	450	100
175	650	200
200	750	200
250	850	250
300	950	300

Locking Band

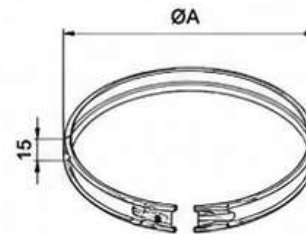

Ø (mm)	A
125	180
150	205
175	230
200	255
250	305
300	355

Adjustable Bracket

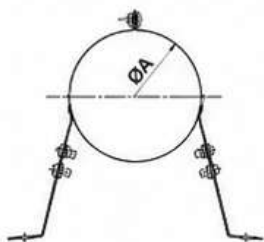

Ø (mm)	A
125	175
150	200
175	225
200	250
250	300
300	350